



Lighting Sciences

www.lightingsciences.com

Lighting Sciences Inc.
7826 E. Evans Road
Scottsdale, Arizona 85260 USA
Tel: 480-991-9260 • Fax: 480-991-0375

INDEPENDENT TEST LABORATORY REPORT No. 27567

ESCO - LOW PRESSURE SODIUM DRUM LUMINAIRE
WITH SPECULAR REFLECTOR AND NO LENS
ONE OSRAM 18 WATT LPS LAMP, CAT# 18W SOX. LUMEN RATING = 1800 LMS.
LAMP OPERATING 18.0 WATTS

INTENSITY (CANDLEPOWER) SUMMARY

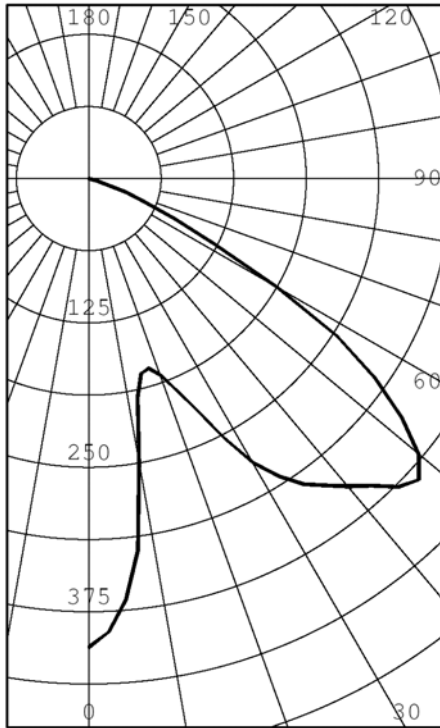

ANGLE	MEAN CP	LUMENS
0	406	
5	366	32
10	249	
15	175	52
20	181	
25	222	106
30	285	
35	323	202
40	348	
45	378	287
50	371	
55	301	261
60	187	
65	82	89
70	34	
75	7	11
80	1	
85	0	0
90	0	

ZONAL LUMENS AND PERCENTAGES

ZONE	LUMENS	% LAMP	%LUMINAIRE
0-30	191	10.59	18.31
0-40	392	21.80	37.69
0-60	941	52.28	90.40
0-90	1041	57.83	100.00
40-90	649	36.03	62.31
60-90	100	5.55	9.60
90-180	0	0.00	0.00
0-180	1041	57.83	100.00

** EFFICIENCY: 57.8% **

LUMINOUS DIAMETER: 9.500 INS

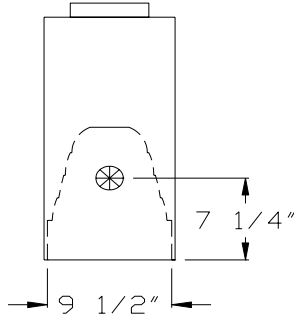

LUMINANCE SUMMARY CD./SQ.M.

ANGLE	MEAN CD/SQ M
45	11728
55	11533
65	4235
75	571
85	0

S/MH: 0.4
SC: 0.4

CERTIFIED BY:

James E. Walker III

DATE:
AUG 30, 2010

PREPARED FOR:
ESCO LIGHTING INC
CHICAGO, IL

TESTED IN ACCORDANCE WITH IES PROCEDURES.

LIGHTING SCIENCES, INC.
7826 E. EVANS RD.
SCOTTSDALE, AZ, USA 85260

INDEPENDENT TEST LABORATORY REPORT No. 27567

ESCO - LOW PRESSURE SODIUM DRUM LUMINAIRE
WITH SPECULAR REFLECTOR AND NO LENS
ONE OSRAM 18 WATT LPS LAMP, CAT# 18W SOX. LUMEN RATING = 1800 LMS.
LAMP OPERATING 18.0 WATTS

INTENSITY (CANDLEPOWER) DATA
IN 2.5 DEGREE STEPS

ANGLE	INTENSITY (CANDLEPOWER)	LUMENS
0.0	406	
2.5	393	
5.0	366	32
7.5	325	
10.0	249	
12.5	194	
15.0	175	52
17.5	172	
20.0	181	
22.5	198	
25.0	222	106
27.5	253	
30.0	285	
32.5	306	
35.0	323	202
37.5	335	
40.0	348	
42.5	361	
45.0	378	287
47.5	386	
50.0	371	
52.5	340	
55.0	301	261
57.5	254	
60.0	187	
62.5	121	
65.0	82	89
67.5	51	
70.0	34	
72.5	14	
75.0	7	11
77.5	3	
80.0	1	
82.5	0	
85.0	0	0
87.5	0	
90.0	0	

LIGHTING SCIENCES, INC.
7826 E. EVANS RD.
SCOTTSDALE, AZ, USA 85260

INDEPENDENT TEST LABORATORY REPORT No. 27567

ESCO - LOW PRESSURE SODIUM DRUM LUMINAIRE
WITH SPECULAR REFLECTOR AND NO LENS
ONE OSRAM 18 WATT LPS LAMP, CAT# 18W SOX. LUMEN RATING = 1800 LMS.
LAMP OPERATING 18.0 WATTS

AVERAGE LUMINANCE DATA

CD./SQ.M (FOOTLAMBERTS)

ANGLE	LUMINANCE
0	8868 (2588)
30	7183 (2096)
40	9934 (2899)
45	11728 (3423)
50	12632 (3687)
55	11533 (3366)
60	8166 (2383)
65	4235 (1236)
70	2164 (631)
75	571 (166)
80	121 (35)
85	0 (0)

LIGHTING SCIENCES, INC.
 7826 E. EVANS RD.
 SCOTTSDALE, AZ, USA 85260

INDEPENDENT TEST LABORATORY REPORT No. 27567

ESCO - LOW PRESSURE SODIUM DRUM LUMINAIRE
 WITH SPECULAR REFLECTOR AND NO LENS
 ONE OSRAM 18 WATT LPS LAMP, CAT# 18W SOX. LUMEN RATING = 1800 LMS.
 LAMP OPERATING 18.0 WATTS

COEFFICIENTS OF UTILIZATION

ZONAL CAVITY METHOD

EFFECTIVE FLOOR CAVITY REFLECTANCE = .20

CC WALL	90				80				70				50				30				10				0	
	70	50	30	10	70	50	30	10	70	50	30	10	50	30	10	50	30	10	50	30	10	50	30	10	0	
RCR	0	0.700	.700	.700	.70	0.690	.690	.690	.69	0.670	.670	.670	.67	0.640	.640	.64	0.620	.620	.62	0.590	.590	.59	0.58			
1	0.650	.630	.610	.59	0.640	.620	.600	.58	0.620	.600	.590	.57	0.580	.560	.55	0.560	.550	.53	0.540	.530	.52	0.51				
2	0.600	.560	.530	.49	0.590	.550	.520	.49	0.580	.540	.510	.48	0.520	.490	.47	0.500	.480	.46	0.480	.470	.45	0.44				
3	0.550	.490	.450	.41	0.540	.480	.440	.41	0.530	.480	.440	.41	0.460	.430	.40	0.440	.420	.39	0.430	.410	.39	0.37				
4	0.510	.440	.390	.35	0.490	.430	.380	.35	0.480	.420	.380	.34	0.410	.370	.34	0.400	.360	.34	0.380	.350	.33	0.32				
5	0.460	.390	.330	.29	0.450	.380	.330	.29	0.440	.370	.320	.29	0.360	.320	.29	0.350	.310	.28	0.340	.310	.28	0.27				
6	0.420	.340	.280	.25	0.410	.330	.280	.24	0.400	.330	.280	.24	0.310	.270	.24	0.300	.270	.24	0.300	.260	.23	0.22				
7	0.380	.290	.240	.20	0.370	.290	.240	.20	0.360	.280	.230	.20	0.270	.230	.20	0.260	.220	.19	0.260	.220	.19	0.18				
8	0.340	.260	.210	.17	0.330	.250	.200	.17	0.330	.250	.200	.17	0.240	.200	.17	0.230	.190	.16	0.230	.190	.16	0.15				
9	0.310	.230	.170	.14	0.310	.220	.170	.14	0.300	.220	.170	.14	0.210	.170	.14	0.210	.170	.14	0.200	.160	.13	0.12				
10	0.280	.200	.150	.12	0.280	.200	.150	.12	0.270	.190	.150	.12	0.190	.140	.12	0.180	.140	.11	0.180	.140	.11	0.10				

LUMINAIRE INPUT WATTS 18.0

LABORATORY RESULTS MAY NOT BE REPRESENTATIVE OF FIELD PERFORMANCE.
 BALLAST AND FIELD FACTORS HAVE NOT BEEN APPLIED.

TEST DISTANCE EXCEEDS FIVE TIMES THE GREATEST
 LUMINOUS OPENING OF LUMINAIRE.